

for internal chamfer measurement,
diameter should be larger than $\varnothing D$

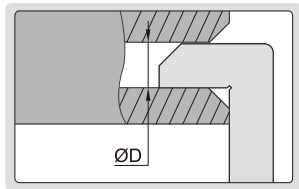

- To measure internal and external chamfers
- Made of stainless steel

Code	Graduation	Accuracy	$\varnothing D$
4844-1	0.5mm	$\pm 0.25\text{mm}$	11mm



4844-1

CHAMFER GAGE

Unit: mm

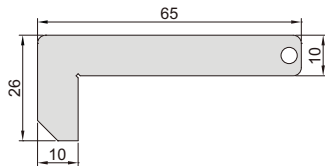

internal chamfer

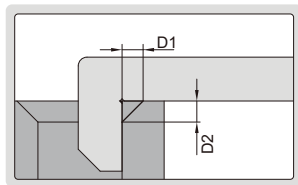

external chamfer

